



CPL™ 15B⁺
Passive Subwoofer



Operating
Manual

Model Number or Name:

Date of Purchase:

Serial Number:

Dealer Name:

Crest Audio® CPL™ 15B⁺

The Crest Audio CPL 15B⁺ is a passive subwoofer designed to extend the performance of the CPL+ series loudspeaker systems down to 37 Hz. It is the ideal add on for music playback, public address and live performance reinforcement applications.

The CPL 15B⁺ can be utilized for both permanent installations and portable live sound applications. Perfect for public address, and background audio reinforcement purposes typically required in houses of worship, clubs, bars/restaurants, retail outlets plus education and corporate meeting facilities or anywhere high quality audio distribution and a powerful low end is required.

The CPL 15B⁺ is equipped with a premium 15 inch woofer having 4 inch voice coil. Impedance of the loudspeaker is 8 Ohms allowing for easy daisy chaining. Connectivity is made via either looping 4-pin twist-lock or 4-pin Euroblock connectors.

The CPL 15B⁺ enclosure is built from prime-grade 18 mm plywood that offers sturdy mechanical and low resonant electro-acoustic characteristics together with a heavy-duty steel grille backed with acoustic foam to ensure maximum protection of the internal components. The loudspeaker is equipped with a M20 threaded pole mount fitting. Available in durable black and white finish.

Features

- Passive subwoofer
- Premium 15" woofers, 4" voice coil
- Continuous power handling: 500 Watts
- Nominal impedance: 8 Ohms
- Connectors: 2 x 4-pin twist-lock & 4-pin Euroblock
- 2+/- Loop Through
- M20 threaded pole mount fitting
- Ergonomic handles on each side
- 18 mm Plywood construction
- Textured polyurea paint
- Available in Black and White

Configuration: Passive subwoofer

Power Handling*: 500 Watts Continuous, 1,000 Watts Program, 2,000 Watts Peak

*To reach the rated power, there must be an infrasonic filter set to 36 Hz, 12 dB / Octave Butterworth minimum filtering.

A higher frequency and/or filter slope is acceptable.

Nominal Impedance: 8 Ohms

Sensitivity (1W/1m): 95 dB

Maximum SPL (1m): 122 dB @ 500 Watts; 128 dB @ 2,000 Watts Peak

Frequency Response*: 49 Hz - 2 kHz, ± 3 dB

*1m on-axis, swept-sine in anechoic environment

Frequency Range*: 37 Hz - 2 kHz, -10 dB

*1m on-axis, swept-sine in anechoic environment

Box Tuning Frequency: 46 Hz

Recommended Crossover Frequency: 24 dB/Octave Linkwitz-Riley set no lower than 100 Hz, and no higher than 160 Hz

Nominal Coverage Pattern (-6 dB): 360° H x 360° V

LF Driver: 1 x 15" (381 mm) Woofer - Crest Audio CPL15100A

LF Driver Voice Coil: 4" (100 mm)

Input Connections: 2 x 4-pin twist-lock (NL-4 style) & 1 x 4-pin Euroblock

Input, Pin 1+ = (+) positive; Pin 1- = (-) negative / Loop Through, Pin 2+ = (+) positive; Pin 2- = (-) negative

Enclosure Material: 0.7" (18 mm) Plywood

Finish: Textured polyurea paint, available in Black & White

Black Finish: RAL: 9004 Signal Black (Pantone: Black 6)

White Finish: RAL: 9003 Signal White (Pantone: 705)

Front: Full-coverage perforated steel grille, backed with acoustically neutral foam

Mounting Provisions: One (1) M20 threaded pole mount fitting on the top of the enclosure, and four (4) low-profile rubber feet on the bottom for stage or floor use

Overall Dimensions (HWD):

Front - 27.38" x 18.56" x 20.08" (695 x 471 x 510 mm)

Net Weight: 79.2 lbs (35.9 kg)

CAUTION

This enclosure is not designed for overhead suspension!

When placing any cabinet above a CPL 15B⁺ subwoofer, be sure that the unit is on flat or level ground for safety and stability.

The maximum length of threaded pole, with adjustable or fixed length, that can be used with the CPL 15B⁺ is 42 inches (1060 mm).

The maximum size of a satellite cabinet that can be placed on such a pole is:

Less than 70 lbs (31.8 kg) and less than 28" (711 mm) high.

Using the proper height threaded pole, the CPL 15B⁺ subwoofer can be used with all other appropriate models in the CPL+ line, when these are fitted with the optional Crest Audio pole mount adapters.

INSTALLATION

A M20 threaded pole mount fitting on top is provided for an optional threaded speaker pole.

WARNING

The CPL 15B⁺ passive subwoofer is very efficient and powerful! This sound system can permanently damage hearing! Use extreme care setting the overall maximum loudness!

The apparent sound level of the CPL 15B⁺ can be deceiving due to its clear, clean sound output. The lack of distortion or obvious distress can make the sound level seem much lower than it actually is. This system is capable of sound pressure levels (SPL) in excess of 128 dB at 1 meter from the speaker!

CPL+ Series Input & Loop Through Schematics

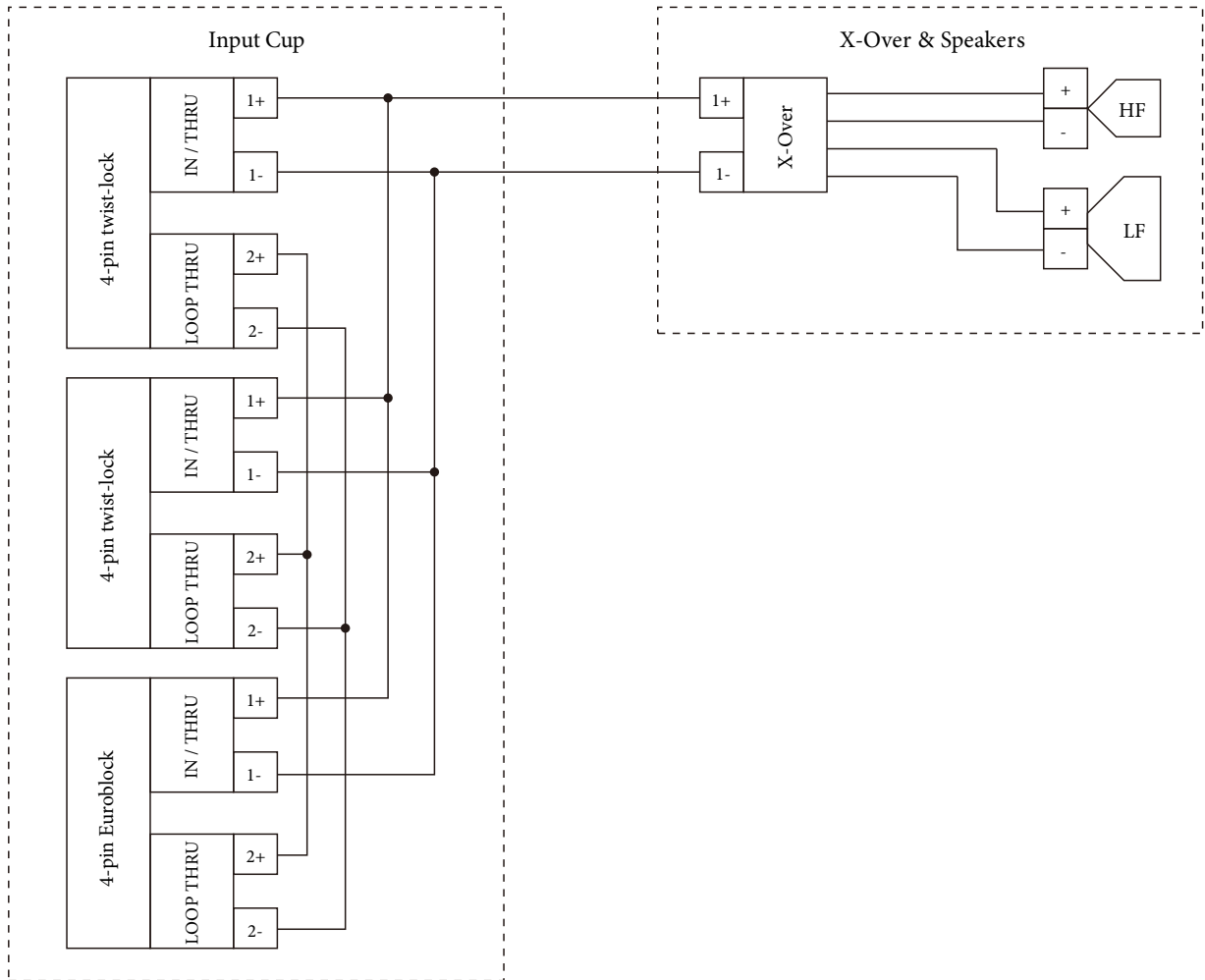

CPL+ Series Loop Through System Schematics

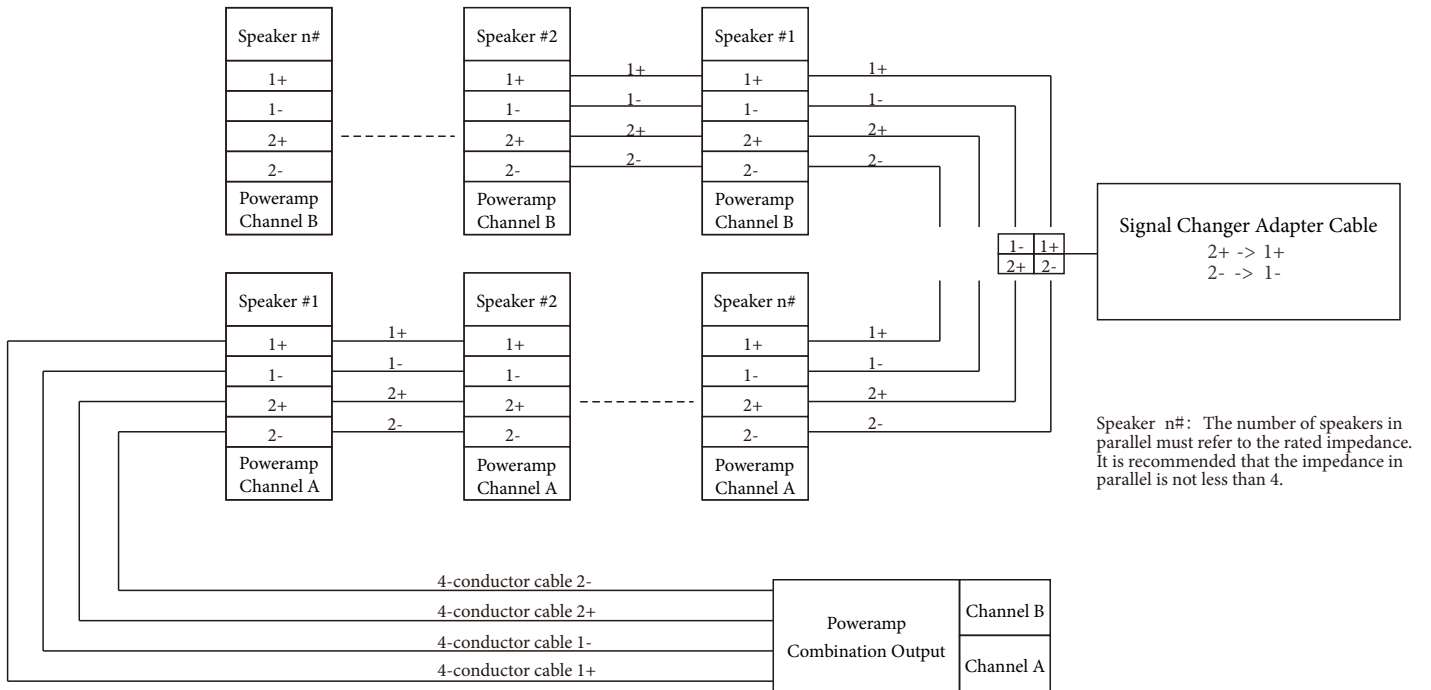

Unit: mm

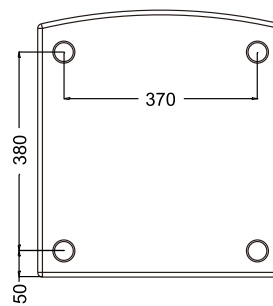
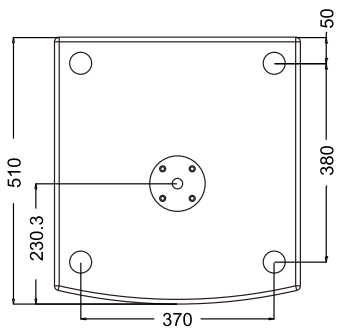
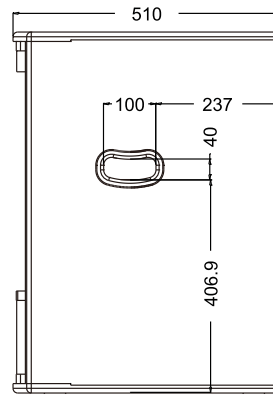
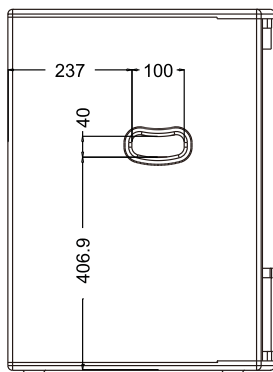
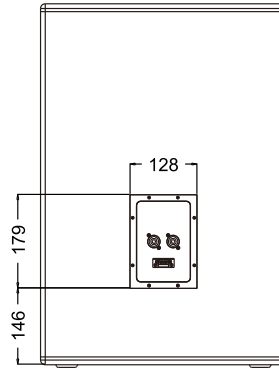
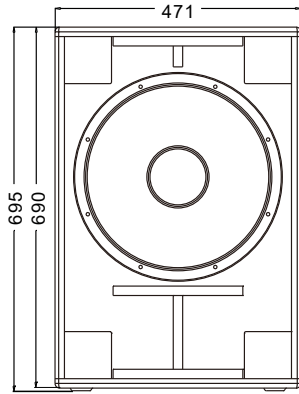

The loudspeaker shall be a passive subwoofer. Its transducers shall be a 15 inch (381 mm) low frequency driver with 4 inch (100 mm) voice coil in a bass reflex enclosure.

Performance specifications of a typical production unit shall be: Measured sensitivity SPL at 1 m (3.3ft) with 2.83V input, shall be 95 dB-SPL. Usable frequency response shall extend from 37 Hz to 2 kHz (10 dB below rated sensitivity, in full space, with no external equalization). Nominal impedance shall be 8 Ohms. Rated power capacity shall be at least 500 Watts continuous power and 2,000 Watts peak power, defined as 6 dB above a test signal of filtered random noise.

The enclosure shall be constructed from prime-grade 18 mm plywood. The grille shall be of heavy-duty steel backed with acoustically transparent foam. The enclosure shall be fitted with a M20 threaded pole-mount plate, and handles on each side. Four low-profile rubber feet shall be provided on the bottom for stage or floor use. The external wiring shall be via either two 4-pin twist-lock or one 4-pin Euroblock connectors. The loudspeaker shall be 27.38 inches (695 mm) high by 18.56 inches (471 mm) wide by 20.08 inches (510 mm) deep weighing 79.2 pounds (35.9 kg). The finish shall be a paintable lightly textured black or white.

The loudspeaker shall be the Crest Audio CPL 15B⁺ subwoofer.

Frequency Response

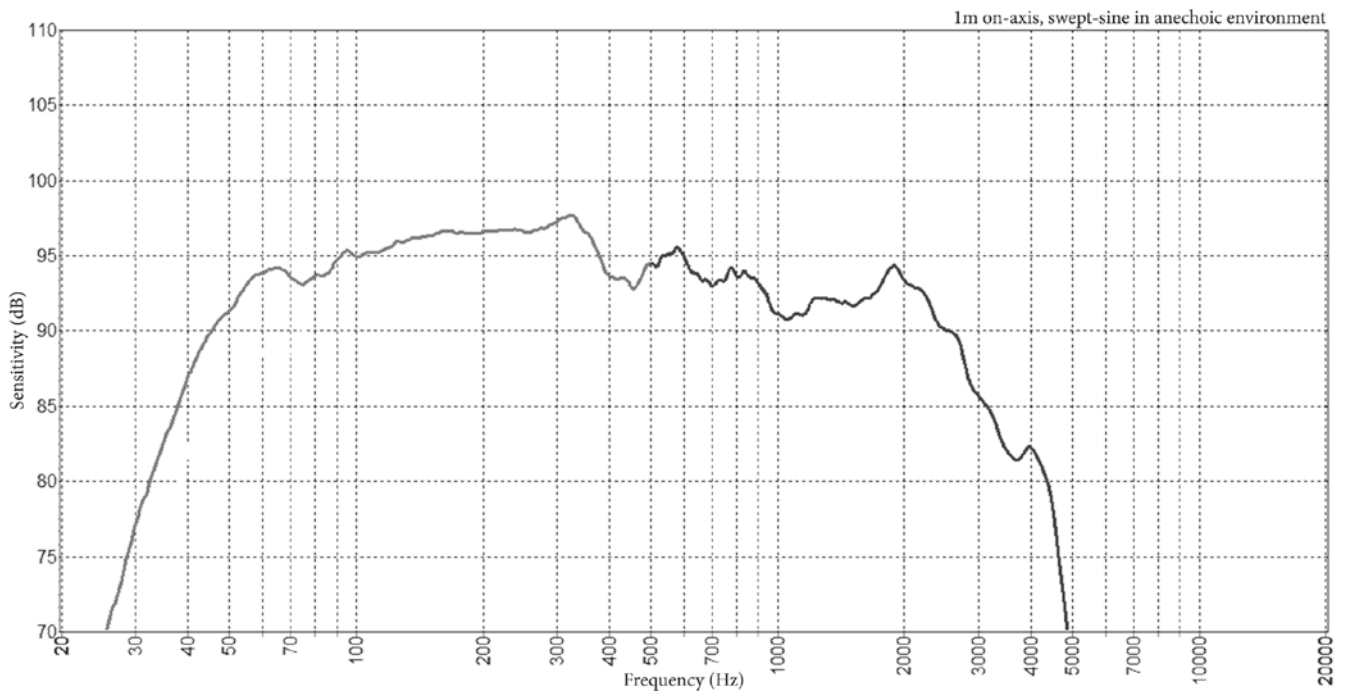

Impedance

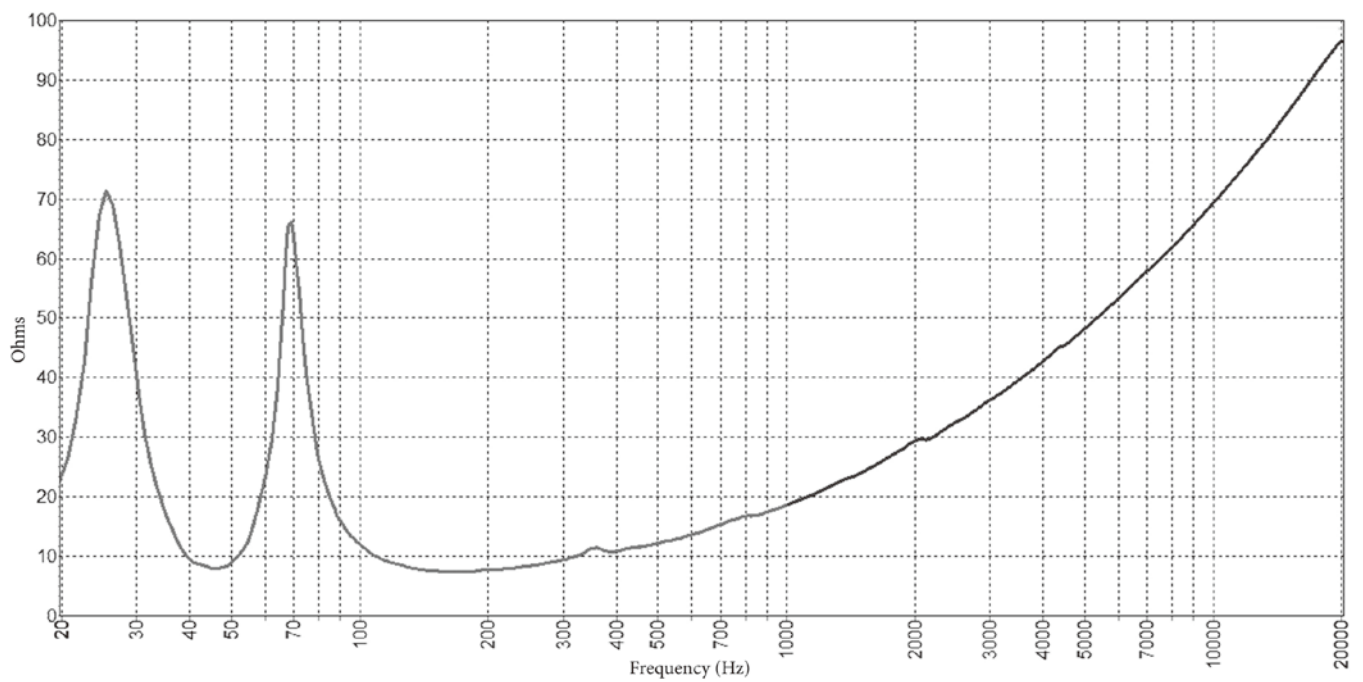



www.crestaudio.com



Features and specifications subject to change without notice.

Crest Audio 5022 HWY 493 N. Meridian, MS 39305 (601) 483-5365 FAX (601) 486-1278



Logo referenced in Directive 2002/96/EC Annex IV
(OJ(L)37/38,13.02.03 and defined in EN 50419: 2005
The bar is the symbol for marking of new waste and
is applied only to equipment manufactured after
13 August 2005